

GENERAL NOTES

- THIS WORK IS THE MAINTENANCE OF TRAFFIC AND THE PROTECTION OF THE TRAVELING PUBLIC APPROACHING THE CONSTRUCTION AREA AND WITHIN THE LIMITS OF CONSTRUCTION.
- FURNISH, ERECT, PLACE AND MAINTAIN TRAFFIC CONTROL SIGNS AND DEVICES. MAINTAIN TRAFFIC DURING HOURS OF CONSTRUCTION AND AT ALL OTHER TIMES IN ACCORDANCE WITH METHODS INDICATED AND THE FOLLOWING:
 - THE SPECIAL PROVISIONS OF THE CONTRACT.
 - PUBLICATION 213, TEMPORARY TRAFFIC CONTROL GUIDELINES, JUNE 2014.
 - PA CODE, TITLE 67, CHAPTER 212, OFFICIAL TRAFFIC CONTROL DEVICES, FEBRUARY 2006.
 - PENNDOT PUBLICATION NO. 35, APPROVED CONSTRUCTION MATERIALS (BULLETIN 15).
 - PENNDOT PUBLICATION NO. 408/2016, SPECIFICATIONS, CHANGE NO. 1.
 - MUTCD, 2009 EDITION.
 - PENNDOT PUBLICATION 111, TRAFFIC CONTROL STANDARDS, DATED JUNE 2013.
 - PENNDOT PUBLICATION 236, HANDBOOK OF APPROVED SIGNS, DATED NOVEMBER 2013.
 - PA CODE, TITLE 67, CHAPTER 204, GUIDELINES TO IMPLEMENT ACT 229, AS DIRECTED.
- MAINTENANCE AND PROTECTION OF TRAFFIC DURING CONSTRUCTION SHALL BE IN ACCORDANCE WITH APPLICABLE FIGURES IN PENNDOT PUBLICATION 213, TEMPORARY TRAFFIC CONTROL GUIDELINES, DATED JUNE 2014, AND TITLE 67 PA CODE, CHAPTER 212, "OFFICIAL TRAFFIC CONTROL DEVICES", DATED FEBRUARY 2006.
- IMMEDIATELY UPON COMPLETION OF THE WORK, REMOVE ALL DEVICES. THE DEVICES ARE TO REMAIN THE PROPERTY OF THE CONTRACTOR UNLESS OTHERWISE SPECIFIED IN THE SPECIAL PROVISIONS. THE DEPARTMENT WILL REMOVE ANY TRAFFIC CONTROL DEVICES ERECTED BY DEPARTMENT FORCES.
- ALL TRAFFIC CONTROL DEVICES TO BE IN PLACE AND INSPECTED BY THE DISTRICT CONSTRUCTION ENGINEER OR HIS REPRESENTATIVE BEFORE WORK BEGINS.
- THIS TRAFFIC CONTROL PLAN DOES NOT RELIEVE THE CONTRACTOR OF HIS OR HER RESPONSIBILITY AS SPECIFIED IN SECTION 901.2(o) OF PUBLICATION NO. 408/2016, CHANGE NO. 1.
- ALL ADVANCED WARNING SIGNS TO REMAIN FUNCTIONAL FOR THE DURATION OF THIS PROJECT.
- ALL DISTANCES MAY BE ADJUSTED SLIGHTLY TO FIT FIELD CONDITIONS.
- RESTORE ALL TRAVEL LANES TO NORMAL TRAFFIC FLOW AT THE CLOSE OF EACH WORK DAY UNDER SHORT-TERM CONDITIONS AND REMOVE OR COVER ALL SHORT-TERM WORK ZONE TRAFFIC CONTROL SIGNING.
- ANY DROP-OFF ADJACENT TO THE TRAVEL LANE, GREATER THAN 2 INCHES, INSTALL SAFETY SLOPE EMBANKMENT. SAFETY SLOPE EMBANKMENT SHALL BE INSTALLED IMMEDIATELY FOLLOWING THE DAYS CONSTRUCTION AND CONTINUOUSLY MAINTAINED UNTIL THE DROP-OFF IS ELIMINATED.
- DURING SHORT-TERM OPERATIONS, NO TRAFFIC RESTRICTIONS OR LANE CLOSURES ARE PERMITTED ON LEGAL HOLIDAYS AND/OR BETWEEN THE HOURS OF 6:00 AM TO 9:00 AM AND 3:00 PM TO 6:00 PM, MONDAY THROUGH FRIDAY.
- USE TYPE VIII REFLECTIVE SHEETING MATERIAL FOR ALL LONG-TERM ADVANCE WARNING SIGNS. TYPE I SHEETING MAY BE USED ON "THIS ROADWAY TO BE UNDER CONSTRUCTION" SIGNS.
- PROTECT ANY EXCAVATING OBSTRUCTIONS OR CONSTRUCTION WORK, SO AS NOT TO EXPOSE PEDESTRIANS TO HAZARDS.
- POST THE SPECIAL SIGN "THIS ROAD TO BE UNDER CONSTRUCTION (START DATE)", TWO WEEKS PRIOR TO THE BEGINNING OF WORK WITHIN THE HIGHWAY RIGHT-OF-WAY AT THE LIMITS OF WORK ON EAST CENTRAL AVENUE. REMOVE THE SIGNS ONCE CONSTRUCTION BEGINS.
- BARRICADES, LIGHTING DEVICES, AND OTHER TRAFFIC CONTROL MEASURES SHALL BE PLACED IN ACCORDANCE WITH AND SHALL CONFORM TO PENNDOT PUBLICATION NO. 408/2016, SPECIFICATIONS, MUTCD, 2009 EDITION, PUBLICATION 213, TEMPORARY TRAFFIC CONTROL GUIDELINES, JUNE 2014, AND PA CODE, TITLE 67, CHAPTER 212, OFFICIAL TRAFFIC CONTROL DEVICES, FEBRUARY 2006.
- TEMPORARILY COVER OR REMOVE ANY SIGNS THAT ARE IN CONFLICT WITH THE TEMPORARY TRAFFIC CONTROL MEASURES. DO NOT ATTACH TAPE OR ADHESIVE TO THE FACE OF ANY SIGNS THAT ARE TEMPORARILY COVERED DURING CONSTRUCTION OPERATIONS. ENSURE, DURING THE REMOVAL AND STORAGE OF ALL SIGNS, THAT THE SHEETING FACE IS NOT DAMAGED OR SCRATCHED. REPLACE IN KIND ALL SIGNS AND/OR POSTS DAMAGED DURING REMOVAL, STORAGE OR REINSTALLATION.
- ALL EXISTING PAVEMENT MARKINGS WHICH ARE NO LONGER APPROPRIATE SHALL BE ERADICATED. PAVEMENT MARKINGS ARE TO BE ERADICATED COMPLETELY BY A METHOD APPROVED BY THE FIELD REPRESENTATIVE.
- MAINTAIN ACCESS TO ALL SIDE ROADS, ALLEYS, PRIVATE DRIVEWAYS, AND BUSINESSES AT ALL TIMES.
- TRAFFIC FLOW WITHIN THE WORK AREA MUST NOT BE STOPPED FOR GREATER THAN A 5 MINUTE PERIOD AT ANY ONE TIME.
- NOTIFY EMERGENCY SERVICES (POLICE, FIRE, MEDICAL, ETC.), LOCAL MUNICIPALITIES, AFFECTED BUSINESSES, SCHOOL DISTRICT(S), AND THE GENERAL PUBLIC AT LEAST FOURTEEN DAYS PRIOR TO IMPLEMENTING TRAFFIC PATTERN CHANGES.
- NOTIFY TREDYFFRIN TOWNSHIP AT LEAST 14 DAYS PRIOR TO STARTING EACH STAGE OF WORK AND WITH ANY OTHER ROAD OR SIDEWALK RESTRICTIONS TO ALLOW PUBLIC NOTICE.
- ALL TEMPORARY PEDESTRIAN FACILITIES TO BE CONSTRUCTED MUST CONFORM TO THE REQUIREMENTS OF THE US ACCESS BOARD, PUBLIC RIGHT-OF-WAY ACCESSIBILITY GUIDELINES (PROWAG) OF THE ACCESSIBILITY GUIDELINES OF BUILDINGS AND FACILITIES (ADAAG).
- INSTALL TEMPORARY PAVEMENT MARKINGS (WITH THE DIRECTION OF THE FIELD REPRESENTATIVE) IN A MANNER THAT WILL MAINTAIN THE PROPER REFLECTIVITY AND STANDARDS IN ACCORDANCE WITH PUBLICATION 408, WHILE ALSO ALLOWING FOR THE TEMPORARY PAVEMENT MARKINGS TO BE SUFFICIENCY ERADICATED PRIOR TO THE INSTALLATION OF THE FINAL PAVEMENT MARKINGS.

SEQUENCE OF CONSTRUCTION

GENERAL NOTES:

- COORDINATE WITH ALL UTILITY COMPANIES TO COMPLETE RELOCATIONS PRIOR TO (OR DURING) THE STAGE WHICH CONSTRUCTION OCCURS.
 - INSTALL EROSION AND SEDIMENT POLLUTION CONTROL MEASURES IN ACCORDANCE WITH THE EROSION AND SEDIMENT POLLUTION CONTROL PLAN.
- STAGE 1: ENTIRE PROJECT**
- INSTALL SHORT TERM ADVANCE WARNING SIGNS IN ACCORDANCE WITH PUBLICATION 213 SHORT TERM TRAFFIC OPERATIONS PATA 102.
 - TRENCH, EXCAVATE AND CONSTRUCT ALL DRAINAGE WITHIN THE T-411 CARTWAY:
 - STA. 21+61 TO STA. 22+10 RT (I-1 TO EXISTING INLET EX-1)
 - STA. 30+18 RT (I-2)
 - STA. 33+07 LT & RT (I-3 TO I-4)

IF NECESSARY, PROVIDE FLAGGING IN ACCORDANCE WITH PATA 107. BACKFILL TRENCHES TO GRADE OR COVER TRENCHES WITH RECESSED PINNED PLATES AT THE END OF EACH WORK DAY BEFORE RESUMING NORMAL TRAFFIC OPERATIONS. TEMPORARILY COVER ALL NEW INLETS.

STAGE 2: STA. 34+75 TO STA. 41+50

- INSTALL LONG TERM ADVANCE WARNING SIGNS IN ACCORDANCE WITH PUBLICATION 213 LONG TERM TRAFFIC OPERATIONS PATA 204 PRIOR TO BEGINNING ALL WORK ALONG EASTBOUND T-411. INSTALL TRAFFIC CONTROL DEVICES AND PORTABLE WATER FILLED BARRIERS IN ACCORDANCE WITH PATA 218, SEPARATING PEDESTRIANS FROM TRAFFIC ALONG THE RIGHT SIDE OF T-411. INSTALL TEMPORARY PROTECTIVE FENCING TO PROTECT PEDESTRIANS FROM THE WORK ZONE.
- PERFORM CLEARING AND GRUBBING WORK ALONG THE RIGHT SIDE OF T-411.
- EXCAVATE AND PERFORM ALL WORK ON THE RIGHT SIDE OF T-411 FOR CONSTRUCTION OF THE DRAINAGE FACILITIES AND SIDEWALK INCLUDING INSTALLATION OF DRAINAGE FROM MH-6 TO MH-7 AND FROM MH-7 TO THE EXISTING INLET EX-7, NEW CURB INSTALLATION, ADA CURB RAMP INSTALLATION, DRIVEWAY ADJUSTMENT, AND PAVEMENT RESTORATION.
- FINE GRADE AND INSTALL TOPSOIL, SEEDING AND SOIL SUPPLEMENTS, EROSION CONTROL MULCH BLANKET (WHERE INDICATED), AND PERFORM ANY LANDSCAPING RESTORATION REQUIRED.
- REMOVE "SIDEWALK CLOSED" SIGN AT STA. 34+67 AND ALL OTHER TEMPORARY TRAFFIC CONTROL MEASURES BEFORE OPENING NEW SIDEWALK TO PEDESTRIAN TRAFFIC. RESTORE VEHICULAR TRAFFIC FLOW TO NORMAL OPERATIONS.
- COMPLETE ALL OPERATIONS OF STAGE 4 BEFORE PROCEEDING TO STAGE 5.

STAGE 3: STA. 26+50 TO STA. 34+75

- INSTALL LONG TERM ADVANCE WARNING SIGNS IN ACCORDANCE WITH PUBLICATION 213 LONG TERM TRAFFIC OPERATIONS PATA 204 PRIOR TO BEGINNING ALL WORK ALONG EASTBOUND T-411. INSTALL TRAFFIC CONTROL DEVICES AND PORTABLE WATER FILLED BARRIERS IN ACCORDANCE WITH PATA 218 SEPARATING PEDESTRIANS FROM TRAFFIC ALONG THE RIGHT SIDE OF T-411. INSTALL TEMPORARY PROTECTIVE FENCING TO PROTECT PEDESTRIANS FROM THE WORK ZONE.
- PERFORM CLEARING AND GRUBBING WORK ALONG THE RIGHT SIDE OF T-411 INCLUDING REMOVAL OF EXISTING TREE LINE FROM STA. 28+50 TO STA. 33+30.
- EXCAVATE AND PERFORM ALL WORK ON THE RIGHT SIDE OF T-411 FOR CONSTRUCTION OF THE DRAINAGE FACILITIES AND SIDEWALK INCLUDING NEW CURB INSTALLATION, ADA CURB RAMP INSTALLATION, BERM CONSTRUCTION, DRIVEWAY ADJUSTMENTS AND DRIVEWAY MILL/OVERLAY, AND PAVEMENT RESTORATION. CONSTRUCT DRAINAGE FACILITIES FROM I-4 TO MH-5, AND MH-5 TO MH-6 AT STA. 34+75. DO NOT ADJUST MORE THAN ONE DRIVEWAY AT A TIME.
- FINE GRADE AND INSTALL TOPSOIL, SEEDING AND SOIL SUPPLEMENTS, EROSION CONTROL MULCH BLANKET (WHERE INDICATED), AND PERFORM ANY LANDSCAPING RESTORATION REQUIRED.
- REMOVE "SIDEWALK CLOSED" SIGN AT STA. 26+50 AND ALL OTHER TEMPORARY TRAFFIC CONTROL MEASURES BEFORE OPENING NEW SIDEWALK TO PEDESTRIAN TRAFFIC.
- COMPLETE ALL OPERATIONS OF STAGE 3 BEFORE PROCEEDING TO STAGE 4.

STAGE 4: STA. 21+00 TO STA. 26+50

- INSTALL LONG TERM ADVANCE WARNING SIGNS IN ACCORDANCE WITH PUBLICATION 213 LONG TERM TRAFFIC OPERATIONS PATA 204 PRIOR TO BEGINNING ALL WORK ALONG EASTBOUND T-411. INSTALL TRAFFIC CONTROL DEVICES AND PORTABLE WATER FILLED BARRIERS IN ACCORDANCE WITH PATA 218, SEPARATING PEDESTRIANS FROM TRAFFIC ALONG THE RIGHT SIDE OF T-411. INSTALL TEMPORARY PROTECTIVE FENCING TO PROTECT PEDESTRIANS FROM THE WORK ZONE AND INSTALL A TEMPORARY ACCESS RAMP AT STA. 21+00.
 - PERFORM CLEARING AND GRUBBING WORK ALONG THE RIGHT SIDE OF T-411.
 - EXCAVATE AND PERFORM ALL WORK ON THE RIGHT SIDE OF T-411 FOR CONSTRUCTION OF THE DRAINAGE FACILITIES AND SIDEWALK INCLUDING NEW CURB INSTALLATION, ADA CURB RAMP INSTALLATION, DRIVEWAY ADJUSTMENTS, AND PAVEMENT RESTORATION. DO NOT ADJUST MORE THAN ONE DRIVEWAY AT A TIME.
 - FINE GRADE AND INSTALL TOPSOIL, SEEDING AND SOIL SUPPLEMENTS, EROSION CONTROL MULCH BLANKET (WHERE INDICATED), AND PERFORM ANY LANDSCAPING RESTORATION REQUIRED.
 - REMOVE TEMPORARY ACCESS RAMP AND "SIDEWALK CLOSED" SIGN AT STA. 21+00 AND ALL OTHER TEMPORARY TRAFFIC CONTROL MEASURES BEFORE OPENING SIDEWALK TO PEDESTRIAN TRAFFIC.
 - COMPLETE ALL OPERATIONS OF STAGE 4 BEFORE PROCEEDING TO STAGE 5.
- STAGE 5: ENTIRE PROJECT**
- INSTALL LONG TERM ADVANCE WARNING SIGNS IN ACCORDANCE WITH PUBLICATION 213 LONG TERM TRAFFIC OPERATIONS PATA 202 PRIOR TO BEGINNING ALL REMAINING WORK ALONG T-411.
 - EXCAVATE AND INSTALL RAISED CROSSWALKS AND ALL REMAINING CURB RAMPS. PROVIDE SHORT TERM TRAFFIC CONTROL OPERATIONS USING FIGURE PATA 107 WHEN REQUIRED. RESTORE NORMAL TRAFFIC CONDITIONS.
 - INSTALL ALL FINAL PAVEMENT MARKINGS, SIGNAGE, AND PERFORM ANY FINAL RESTORATION UNDER SHORT TERM TRAFFIC CONTROL OPERATIONS.
 - REMOVE ALL TEMPORARY EROSION AND SEDIMENT POLLUTION CONTROL MEASURES.
 - REMOVE TEMPORARY TRAFFIC CONTROL MEASURES.

DISTRICT	COUNTY	ROUTE	SECTION	SHEET
6-0	CHESTER	T-411	ECA	1 OF 5
TREDYFFRIN TOWNSHIP				
REVISION NUMBER	REVISIONS	DATE	BY	

SHEET INDEX

DESCRIPTION	SHEET
GENERAL NOTES/CONSTRUCTION SEQUENCE	1
TABULATION SHEET/TYPICAL SECTION	2
CONSTRUCTION PHASES	3-5

TRAFFIC CONTROL PLAN

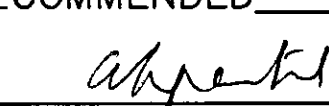
RECOMMENDED 12/8/2016

 DISTRICT TRAFFIC ENGINEER

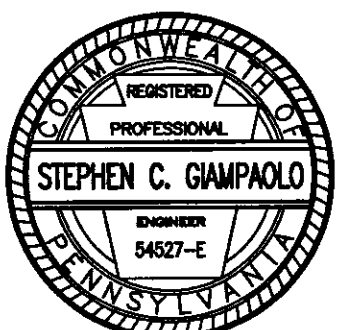
PREPARED BY:
 MCMAHON ASSOCIATES INC
 840 SPRINGDALE DRIVE
 EXTON, PA 19341



 STEPHEN C. GIAMPAOLO, P.E.

DATE: 11-29-2016

TABULATION OF TRAFFIC CONTROL ITEMS				
ITEM NUMBER	STD. SIGN NUMBER	QUANTITY	SIZE	DESCRIPTION
0901-0001 MAINTENANCE AND PROTECTION OF TRAFFIC DURING CONSTRUCTION (FOR INFORMATION ONLY)	G20-2	8	36"x18"	END ROAD WORK
	R9-9	6	24"x12"	SIDEWALK CLOSED SIGN
	W1-1L	6	30"x30"	LEFT TURN
	W1-4R	6	30"x30"	RIGHT REVERSE CURVE
	W5-5	6	36"x36"	LANE SHIFT
	W20-1	14	36"x36"	ROAD WORK
	W20-4	4	36"x36"	ONE LANE ROAD
	W20-7	4	36"x36"	FLAGGER SYMBOL
	W21-5	1	30"x30"	SHOULDER WORK
	W21-SBR	1	30"x30"	RIGHT SHOULDER CLOSED ()
	SPECIAL 1	1	60"x30"	"THIS ROAD TO BE UNDER CONSTRUCTION <DATE>"
	----	12		TYPE III BARRICADES
	----	84		CHANNELIZING DEVICES
	----	22		CHANNELIZING DEVICES-PANEL
	ITEM NUMBER	QUANTITY	UNIT	DESCRIPTION
0627-2092	813	LF	TEMPORARY BARRIER, WATER-FILLED, TRITON	
0628-2092	1196	LF	RESET TEMPORARY BARRIER, WATER-FILLED, TRITON	
0901-0240	100	SF	ADDITIONAL TRAFFIC CONTROL SIGNS	
0901-0320	4952	LF	4" STANDARD PAVEMENT MARKINGS, PAINT & BEADS, YELLOW	
0937-0213	30	EACH	BARRIER MOUNTED DELINIATOR, TOP MOUNT, TYPE WZ, (O/B)	
0963-0001	3043	SF	PAVEMENT MARKING REMOVAL	
9000-0004	825	LF	TEMPORARY PROTECTIVE FENCE	

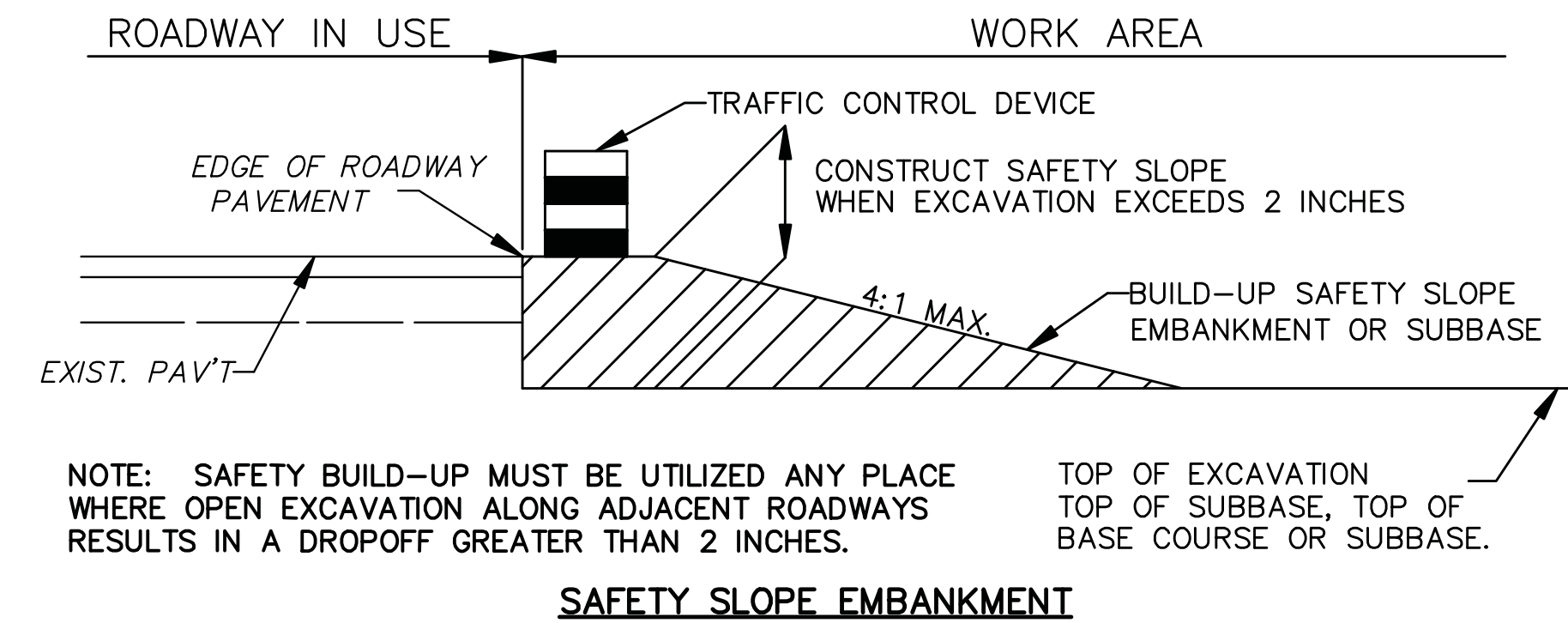

- TRAFFIC CONTROL PLAN NOTES:**
1. INSTALL ALL BARRIERS AND BARRIER END TREATMENTS PER PUBLICATION NO. 408/2016, PER THE MANUFACTURER'S RECOMMENDATIONS, AS INDICATED, AND AS DIRECTED. **BARRIER AND END TREATMENTS TO MEET TEST LEVEL 2 CRITERIA.**
 2. DELINIATE ALL BARRIERS LONGITUDINALLY IN ACCORDANCE WITH TC 8604.
 3. PLACE VERTICAL PANEL (OR SIMILAR DELINIATION) IN FRONT OF ALL EXPOSED BARRIER ENDS FOR DELINIATION.

- LEGEND**
- LONG-TERM WORK AREA
 - CHANNELIZING DEVICE (SECTION VIEW)
 - DY/4" TEMPORARY PAVEMENT MARKING
 - TRAFFIC FLOW ARROW
 - BARRIER MOUNTED DELINIATOR

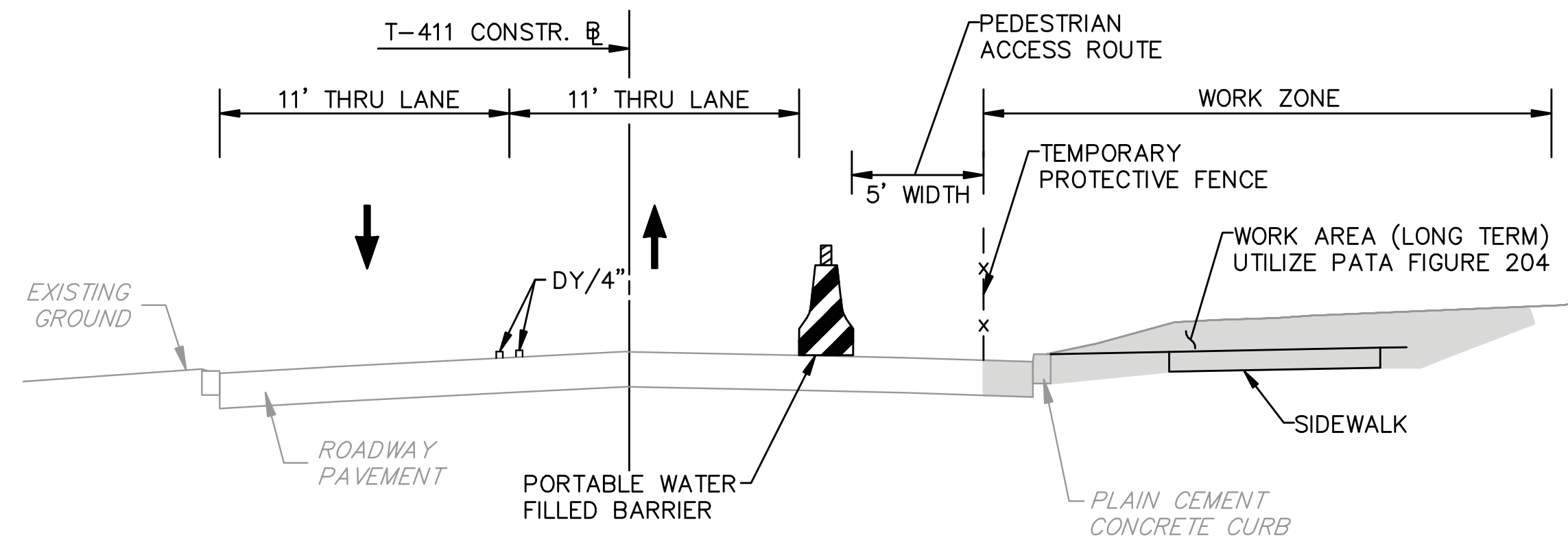

STAGE 2,3,4 - TYPICAL LONG TERM TRAFFIC CONTROL SECTION
NOT TO SCALE

TRAFFIC CONTROL PLAN	
----------------------	--

DISTRICT	COUNTY	ROUTE	SECTION	SHEET	
6-0	CHESTER	T-411	ECA	3 OF 5	
TREDYFFRIN TOWNSHIP					
REVISION NUMBER	REVISIONS			DATE	BY

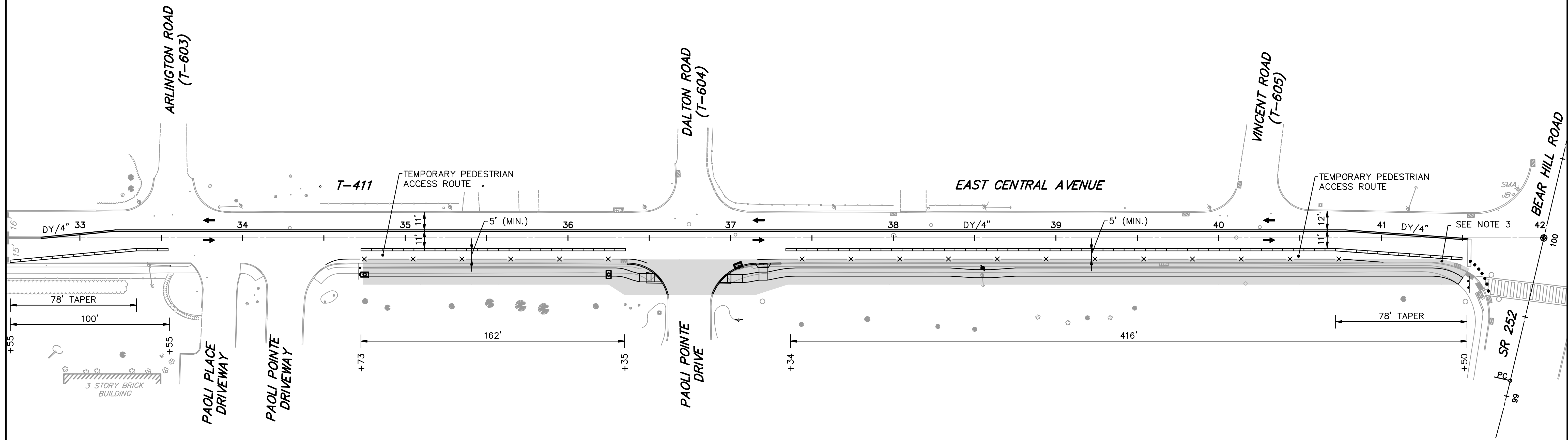
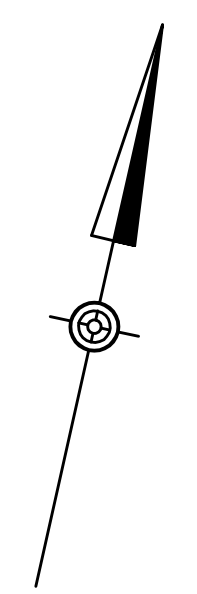

- NOTES:**
1. INSTALL ALL CHANNELIZING DEVICES AND PAINT AS SHOWN AND IN ACCORDANCE WITH THE PATA FIGURES REFERENCED IN THE SEQUENCE OF CONSTRUCTION.
 2. INSTALL TEMPORARY SIGNS IN ACCORDANCE WITH THE PATA FIGURES REFERENCED IN THE SEQUENCE OF CONSTRUCTION.
 3. IF A 5' PEDESTRIAN ACCESS ROUTE CAN NOT BE MAINTAINED BETWEEN STATION 41+00 AND STATION 41+50 PROVIDE A MINIMUM 4' WIDE ACCESSIBLE PATH FOR A MAXIMUM OF 200'.

- LEGEND**
- LONG-TERM WORK AREA
 - PORTABLE WATER FILLED BARRIER
 - CHANNELIZING DEVICE (PLAN VIEW)
 - TYPE III BARRICADE W/ "SIDEWALK CLOSED" SIGN
 - DY/4" TEMPORARY PAVEMENT MARKING
 - TRAFFIC FLOW ARROW
 - x-x- TEMPORARY PROTECTIVE FENCE ITEM 9000-0004

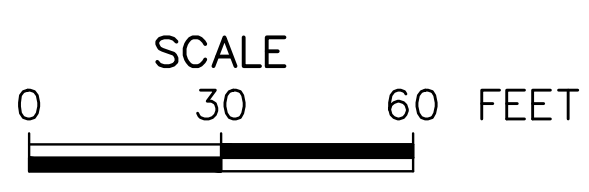

TRAFFIC CONTROL PLAN

STAGE 2

DISTRICT	COUNTY	ROUTE	SECTION	SHEET	
6-0	CHESTER	T-411	ECA	4 OF 5	
TREDYFFRIN TOWNSHIP					
REVISION NUMBER	REVISIONS			DATE	BY

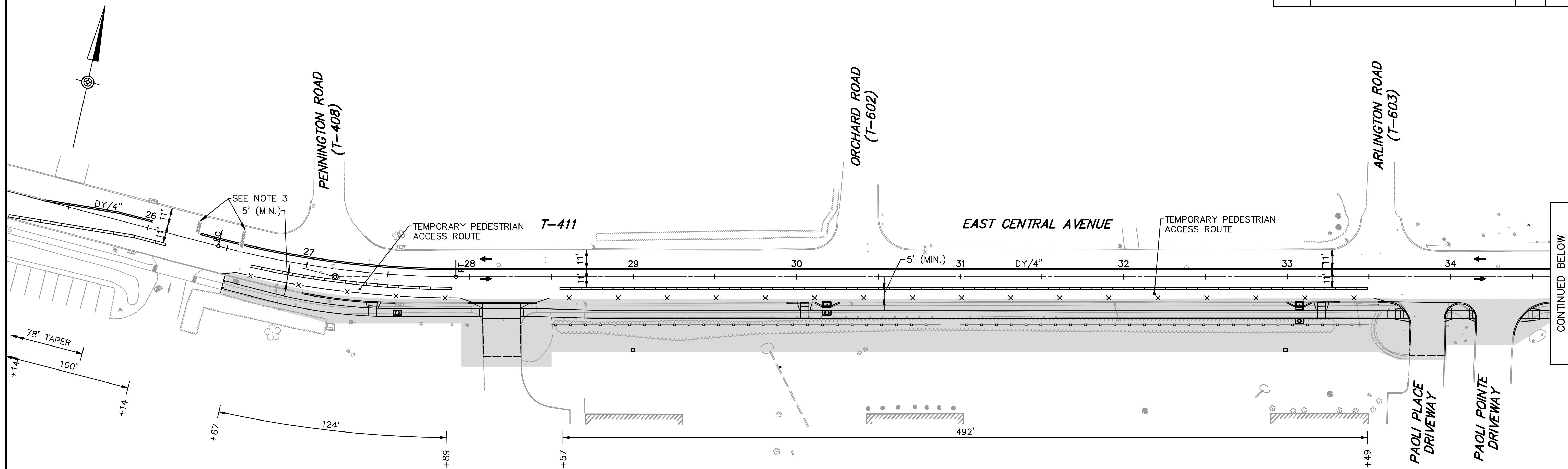

CONTINUED BELOW

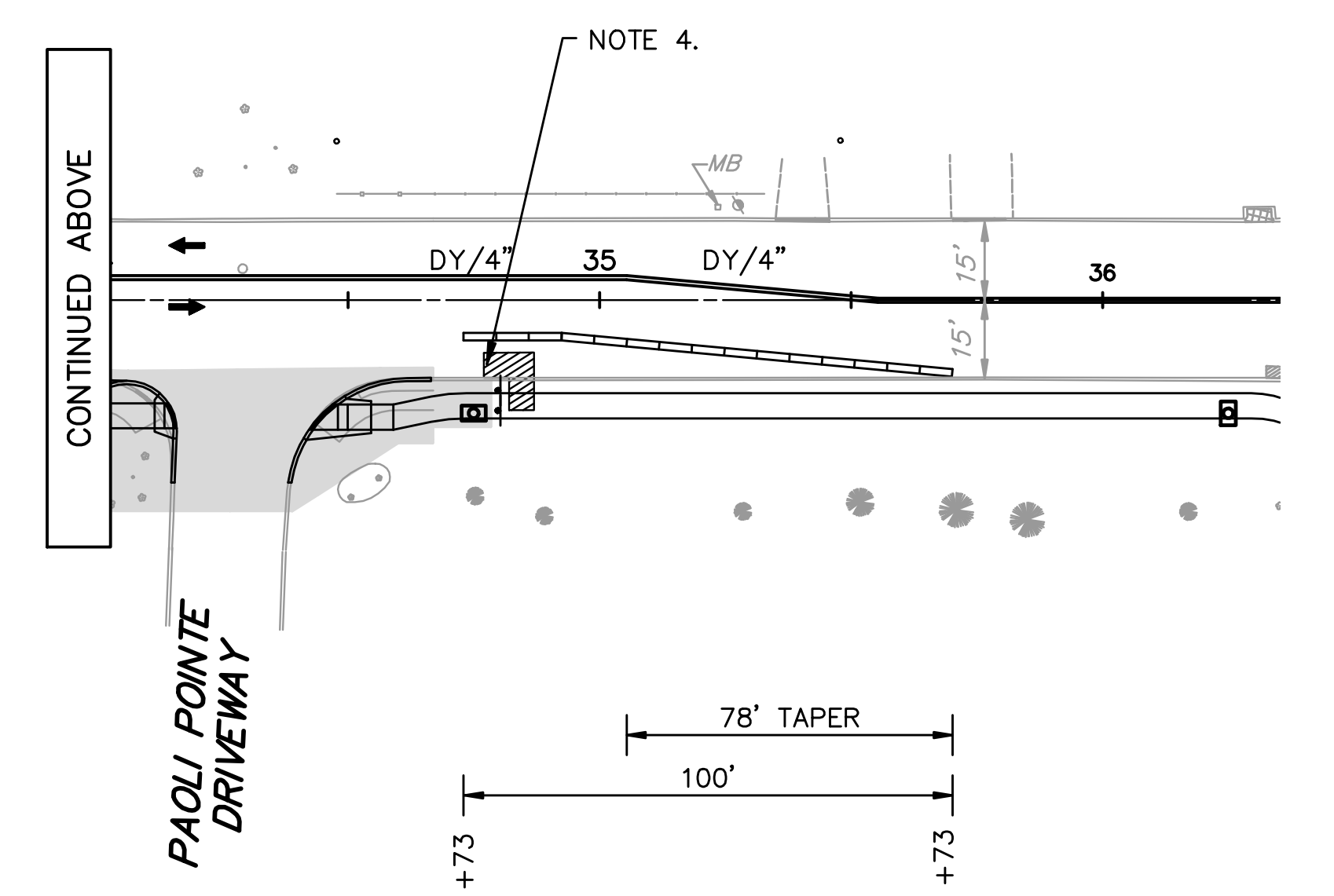

- NOTES:**
1. INSTALL ALL CHANNELIZING DEVICES AND PAINT AS SHOWN AND IN ACCORDANCE WITH THE PATA FIGURES REFERENCED IN THE SEQUENCE OF CONSTRUCTION.
 2. INSTALL TEMPORARY SIGNS IN ACCORDANCE WITH THE PATA FIGURES REFERENCED IN THE SEQUENCE OF CONSTRUCTION.
 3. PRESERVE EXISTING "SCHOOL ZONE" PAVEMENT MARKING LEGEND DURING TEMPORARY TRAFFIC CONTROL SETUP.
 4. PROVIDE ACCESSIBLE CONNECTION TO TEMPORARY PEDESTRIAN ACCESS ROUTE. THIS WORK IS INCIDENTAL TO ITEM 0901-0001.

- LEGEND**
- LONG-TERM WORK AREA
 - PORTABLE WATER FILLED BARRIER
 - CHANNELIZING DEVICE (PLAN VIEW)
 - TYPE III BARRICADE W/ "SIDEWALK CLOSED" SIGN
 - DY/4" TEMPORARY PAVEMENT MARKING
 - TRAFFIC FLOW ARROW
 - x-x- TEMPORARY PROTECTIVE FENCE ITEM 9000-0004

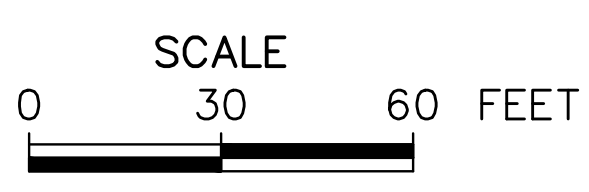

TRAFFIC CONTROL PLAN

STAGE 3

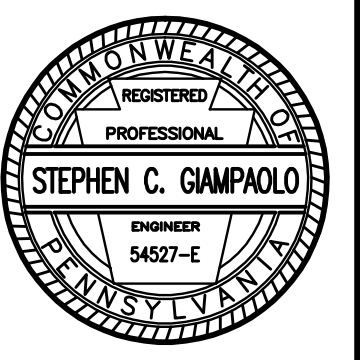

DISTRICT	COUNTY	ROUTE	SECTION	SHEET	
6-0	CHESTER	T-411	ECA	5 OF 5	
TREDYFFRIN TOWNSHIP					
REVISION NUMBER	REVISIONS			DATE	BY

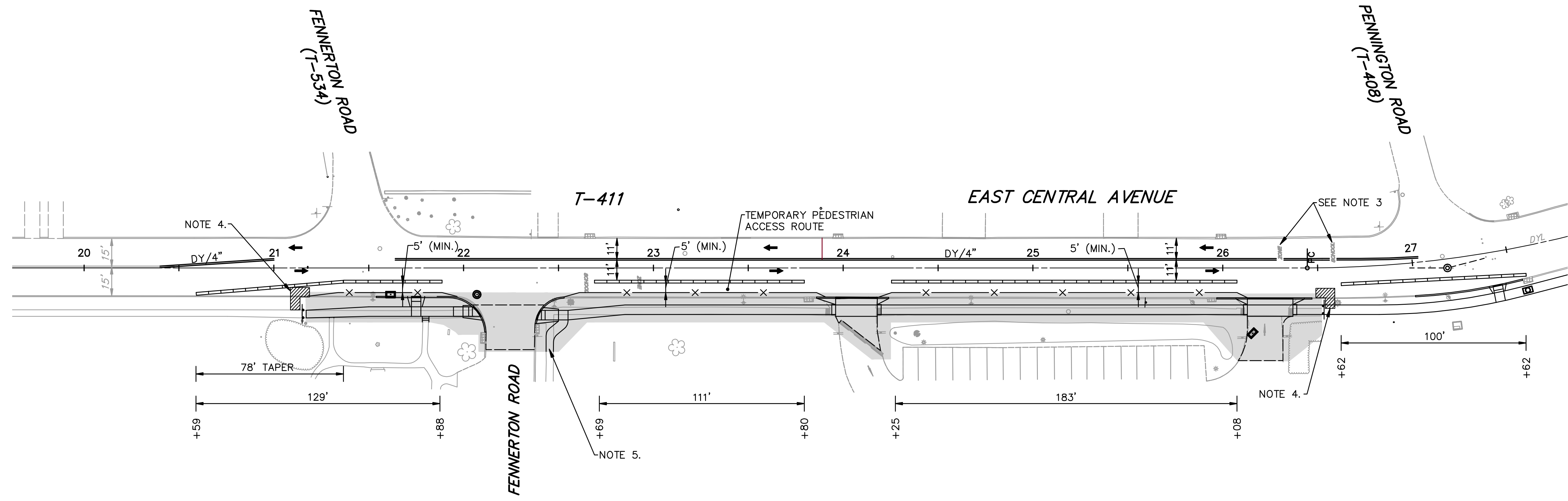
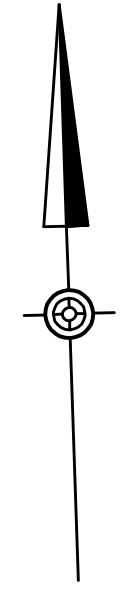

- NOTES:**
1. INSTALL ALL CHANNELIZING DEVICES AND PAINT AS SHOWN AND IN ACCORDANCE WITH THE PATA FIGURES REFERENCED IN THE SEQUENCE OF CONSTRUCTION.
 2. INSTALL TEMPORARY SIGNS IN ACCORDANCE WITH THE PATA FIGURES REFERENCED IN THE SEQUENCE OF CONSTRUCTION.
 3. PRESERVE EXISTING "SCHOOL ZONE" PAVEMENT MARKING LEGEND DURING TEMPORARY TRAFFIC CONTROL SETUP.
 4. PROVIDE ACCESSIBLE CONNECTION TO TEMPORARY PEDESTRIAN ACCESS ROUTE. THIS WORK IS INCIDENTAL TO ITEM 0901-0001.
 5. IMMEDIATELY UPON COMPLETION OF CURB RAMP OPEN SIDEWALK TO PEDESTRIAN TRAFFIC TO PROVIDE ACCESS TO DELAWARE VALLEY FRIENDS SCHOOL.

- LEGEND**
- LONG-TERM WORK AREA
 - PORTABLE WATER FILLED BARRIER
 - CHANNELIZING DEVICE (PLAN VIEW)
 - TYPE III BARRICADE W/ "SIDEWALK CLOSED" SIGN
 - DY/4" TEMPORARY PAVEMENT MARKING
 - TRAFFIC FLOW ARROW
 - x-x- TEMPORARY PROTECTIVE FENCE ITEM 9000-0004



TRAFFIC CONTROL PLAN

STAGE 4